

Porter Ave.

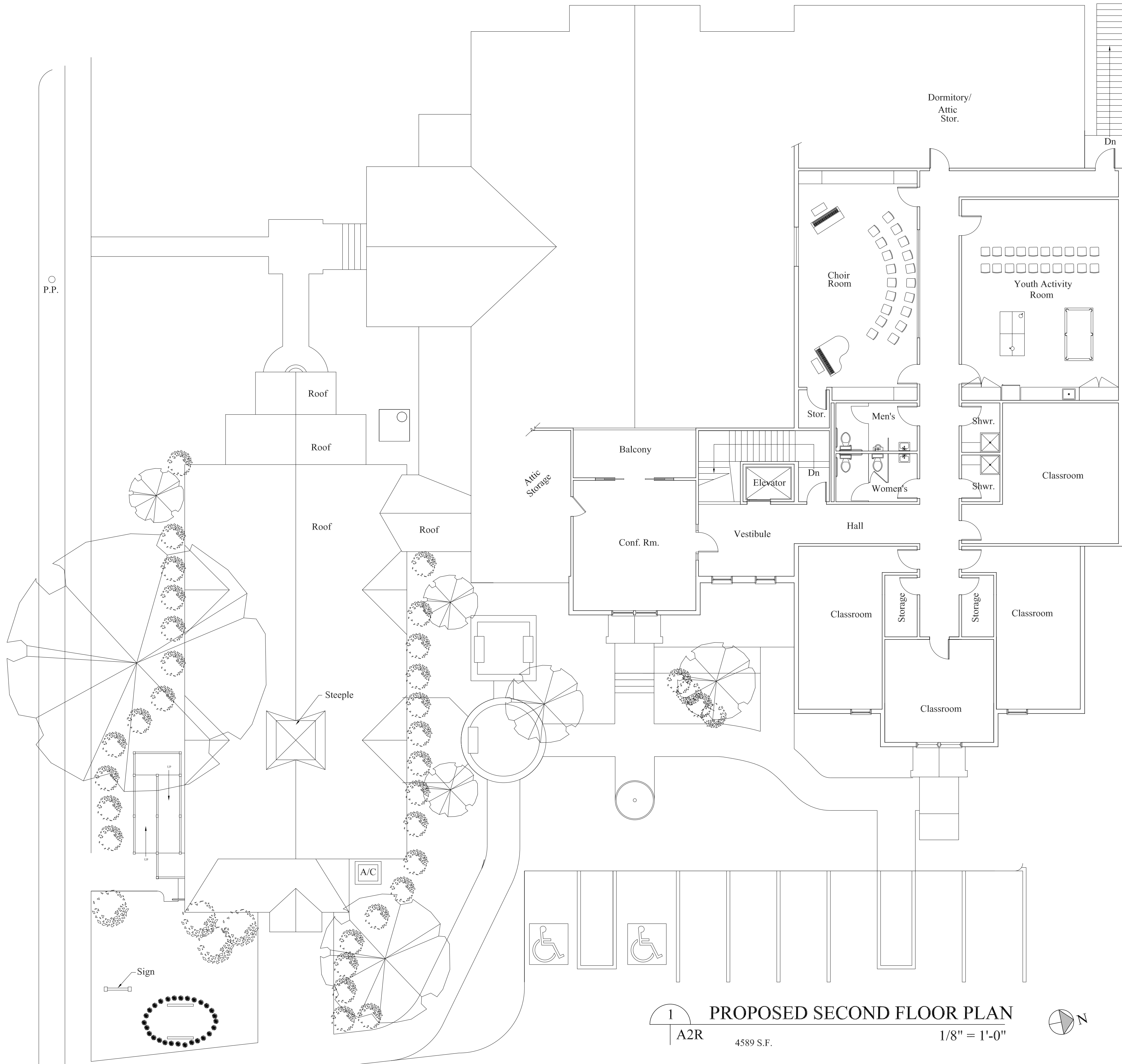

1 PROPOSED SECOND FLOOR PLAN
 A2R 4589 S.F. 1/8" = 1'-0" N

Rayburn Ave.

COWART ARCHITECTS PC
 710 PORTER AVENUE
 OCEAN SPRINGS, MS 39564

REVISIONS:

St. John's Episcopal Church
 705 Porter Avenue
 Ocean Springs, Mississippi 39564

DATE: 03/09/06
 PROJ. NO. 05048-10
 DRAWN: DKC/JLY
 CHECKED: DKC

SHEET NO.
A2R